

RMMG RECESSED REMOTE

MR16 RECESSED CEILING ADJUSTABLE GIMBAL 6 V, 12 V, & 24 V LAMPS

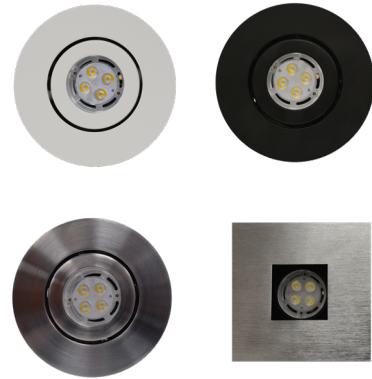
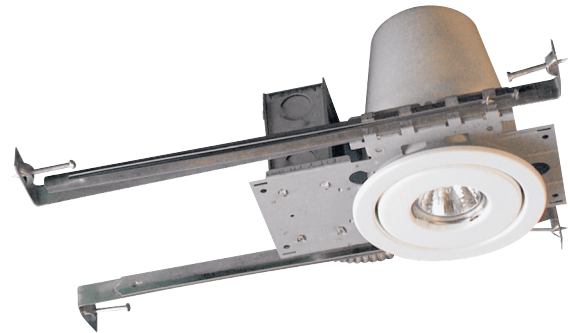

The RMMG series of commercial recessed MR16 remotes has been designed to blend seamlessly into modern decors. The backbox can be mounted in a variety of ways above suspended or drywall ceilings, leaving only the lamp and compact trim plate visible. Trimplates snap into the housing and come in a variety of colours and finishes. The RMMG is available in 6 V, 12 V, and 24 V models, all utilizing low glare, MR16 quartz halogen or LED lamps.

FEATURES & SPECIFICATIONS



MECHANICAL

- Steel housing/backbox and trim plate
- Backbox recesses completely above ceiling
- Backbox c/w plaster ring and adjustable T-bar or nail-in hanger bars
- Adjustable gimbal mounted lamp
- White trim paint finish is standard, other colors and finishes are optional

- MR16 lamp designed with low glare reflector and available in 6 VDC, 12 VDC or 24 VDC

COMPLIANCES

- Compliant with CSA C22.2 #141-15
- Meets requirement of ICES-005

OVERVIEW			
LIGHT SOURCE	LED	INPUT VOLTAGE (VDC)	6, 12, 24
 NUCLEUS COMPATIBLE  ICES 005 			

For complete warranty details, please see our terms and conditions on our website.

Data is based upon tests performed in a controlled environment. Actual performance can vary depending on operating conditions. All products are subject to change or may be discontinued any time without notice.

ORDERING GUIDE - LED

SERIES	NUMBER OF HEADS	VOLTS [VDC OPERATIONAL]	WATTS [W]	LAMP TYPE	COLOR	OPTIONS
RMMG	1 - SINGLE HEAD	06 - 24 - 6 TO 12	4W - 4	LR - LED	WH - WHITE (STANDARD) BK - BLACK SCH - SATIN CHROME CUS - CUSTOM COLOUR (SPECIFY)	SQ - SQUARE TRIM ¹
			5W - 5	LA - LED		
		12 - 24 - 12 TO 24	6W - 6	LA - LED		
			7W - 7			
		NUC - NUCLEUS DRIVER	5W - 5	LA - LED		

¹ For Black square trim, contact your rep for availability

LUMEN TABLE

WATTS	LUMENS
4W LR	388
5W LA	435
6W LA	507
7W LA	652

DIMENSIONS

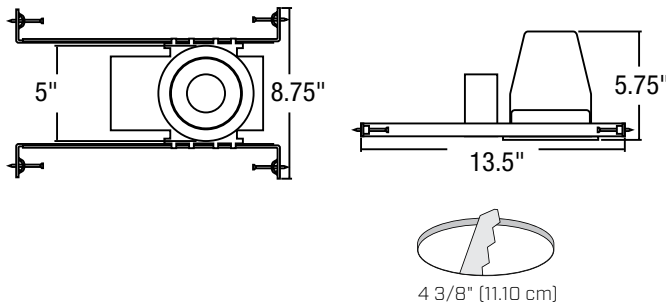

PHOTOMETRIC DATA¹

MR16-06-24V4WLR • 228.7 LM

POLAR CANDELA DISTRIBUTION

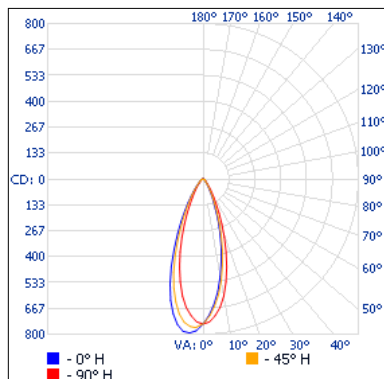

ZONAL LUMEN SUMMARY

ZONE	LUMENS	FIXTURE
0-30	164.4	71.9
0-40	182.0	79.6
0-60	214.8	93.9
60-90	13.9	6.1
70-100	4.1	1.8
90-120	0	0
0-90	228.7	100
90-180	0	0
0-180	228.7	100

ILLUMINANCE AT A DISTANCE

CENTER BEAM FC		BEAM WIDTH
1.7'	168	
3.3'	44.5	2.1'
5.0'	19.4	3.2'
6.7'	10.8	4.3'
8.3'	7.04	5.3'
10.0'	4.85	6.4'

■ Beam Spread: 35.4°

¹ Complete IES files available on our website.

PHOTOMETRIC DATA¹

MR16-06-24V5WLA • 440.7 LM

POLAR CANDELA DISTRIBUTION

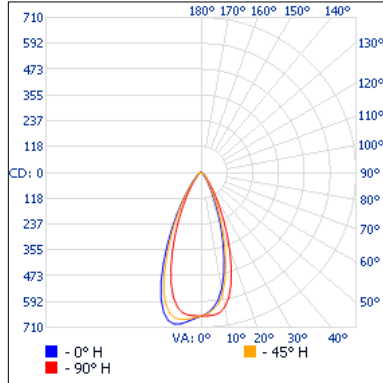

ZONAL LUMEN SUMMARY

ZONE	LUMENS	% FIXTURE
0-30	352.6	80
0-40	391.8	88.9
0-60	427.2	96.9
60-90	13.5	3.1
70-100	4.3	1
90-120	0	0
0-90	440.7	100
90-180	0	0
0-180	440.7	100

ILLUMINANCE AT A DISTANCE

CENTER BEAM FC		BEAM WIDTH	
1.7'	407	0.9'	1.0'
3.3'	108	1.7'	1.9'
5.0'	47.0	2.6'	2.8'
6.7'	26.2	3.5'	3.8'
8.3'	17.1	4.3'	4.7'
10.0'	11.8	5.2'	5.7'

■ Vert. Spread: 29.3° ■ Hor. Spread: 31.7°

MR16-12-24V6WLA • 508.7 LM

POLAR CANDELA DISTRIBUTION

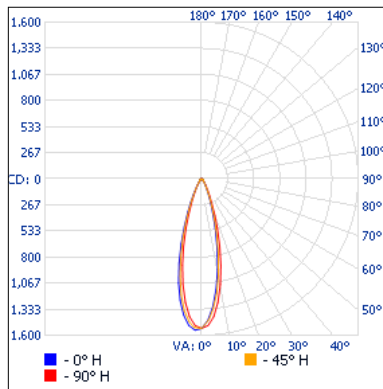

ZONAL LUMEN SUMMARY

ZONE	LUMENS	% FIXTURE
0-30	407.0	80
0-40	452.3	88.9
0-60	493.1	96.9
60-90	15.6	3.1
70-100	4.9	1
90-120	0	0
0-90	508.7	100
90-180	0	0
0-180	508.7	100

ILLUMINANCE AT A DISTANCE

CENTER BEAM FC		BEAM WIDTH	
1.7'	470	0.9'	1.0'
3.3'	125	1.7'	1.9'
5.0'	54.3	2.6'	2.8'
6.7'	30.2	3.5'	3.8'
8.3'	19.7	4.3'	4.7'
10.0'	13.6	5.2'	5.7'

■ Vert. Spread: 29.3° ■ Hor. Spread: 31.7°

MR16-06-24V7WLA • 635.2 LM

POLAR CANDELA DISTRIBUTION

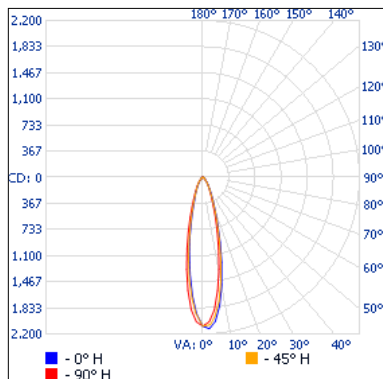

ZONAL LUMEN SUMMARY

ZONE	LUMENS	% FIXTURE
0-30	508.2	80
0-40	564.7	88.9
0-60	615.7	96.9
60-90	19.5	3.1
70-100	6.1	1
90-120	0	0
0-90	635.2	100
90-180	0	0
0-180	635.2	100

ILLUMINANCE AT A DISTANCE

CENTER BEAM FC		BEAM WIDTH	
1.7'	587	0.9'	1.0'
3.3'	156	1.7'	1.9'
5.0'	67.8	2.6'	2.8'
6.7'	37.8	3.5'	3.8'
8.3'	24.6	4.3'	4.7'
10.0'	16.9	5.2'	5.7'

■ Vert. Spread: 29.3° ■ Hor. Spread: 31.7°

¹ Complete IES files available on our website.